

State of South Carolina
 of district above the ancient
 Boundary. Pursuant to a war-
 rant from John Thomas Esq. Com-
 =missioner of Locations. Dated the 14th
 Day of Oct^r 1787. I have admea-
 =sured & laid out unto Abner
 South, a tract of land containing
 Two Hundred acres, situate lying
 of being on the small branches of Pacolet River, including a large pile of
 of rocks on the top of Galesburg mountain, bounded on every side by vac-
 =ant land, and hath such shape & marks as the above plat represents
 Surveyed the 5th Day of October 1787 - by Andrew Thomson Esq
 Recorded this 12th Day of October 1787

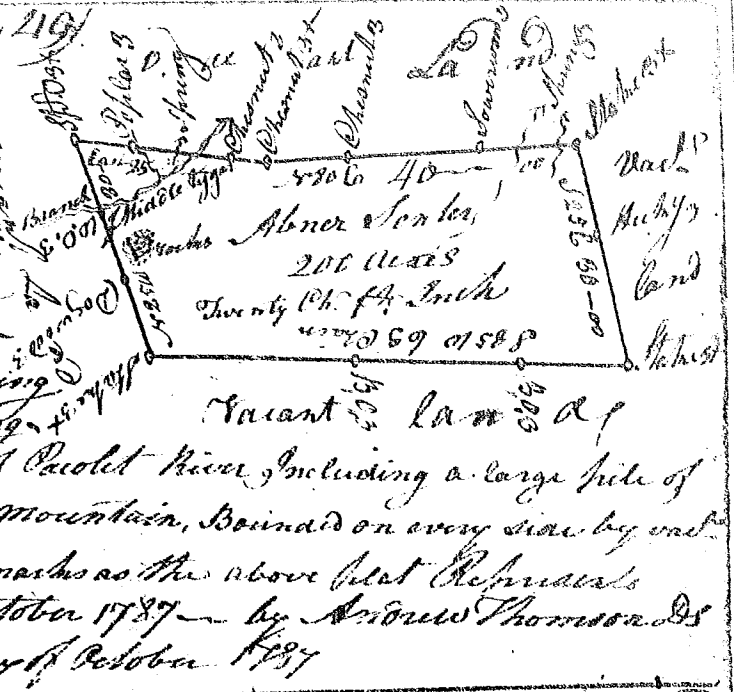

State of S. Carolina Pursuant to a warrant from
 John Thomas Esq. Com^r Dated the
 6th Oct^r 1787. I have admeasured
 & laid out unto Jonathan Nisbitt
 a tract of land containing one hundred
 =and thirty three acres. Situate
 in Spartanburgh County, Between the
 middle forks of Tugal river on small branches of
 middle fork of said river, bounded N.E. by Jonathan Nisbitt's land and land
 =ed for Elhanah Hutchings, N.W. by an old line the owners unknown Sec^d
 by Joseph Nisbitt & Jonathan Nisbitt's land, & hath such form & marks
 as the above plat represents Surveyed the 8th Oct^r 1787
 Recorded 24th Oct^r 1787 J. T. Lam. Nisbitt And, Thomson Esq



State of South Carolina Pursuant
 to a warrant from John Thomas
 Esq. Com^r of Locations. Dated the
 I have admeasured & laid out unto
 Jeremiah Chandler, a tract of
 235 acres of land, on brushy
 Creek of Sandy river in Greenville
 County. Having such form,
 =marks & boundaries & bound-
 =ings as the plat represents
 137 Surveyed the 30th Aug^t 1787
 Recorded the 23rd Oct^r 1787

